

# TOWNSHIPS 4,5&6 N., RANGE 39 E.W.M.

## UMATILLA COUNTY OREGON

CHAS. F. METSKER, CIVIL ENGINEER  
215 COMMERCE BLDG. PORTLAND, ORE.  
930 1/2 PACIFIC AVE. TACOMA, WASH.

SCALE 2 IN. = 1 MILE.  
DATED 1932

### 4 N. 39 E.

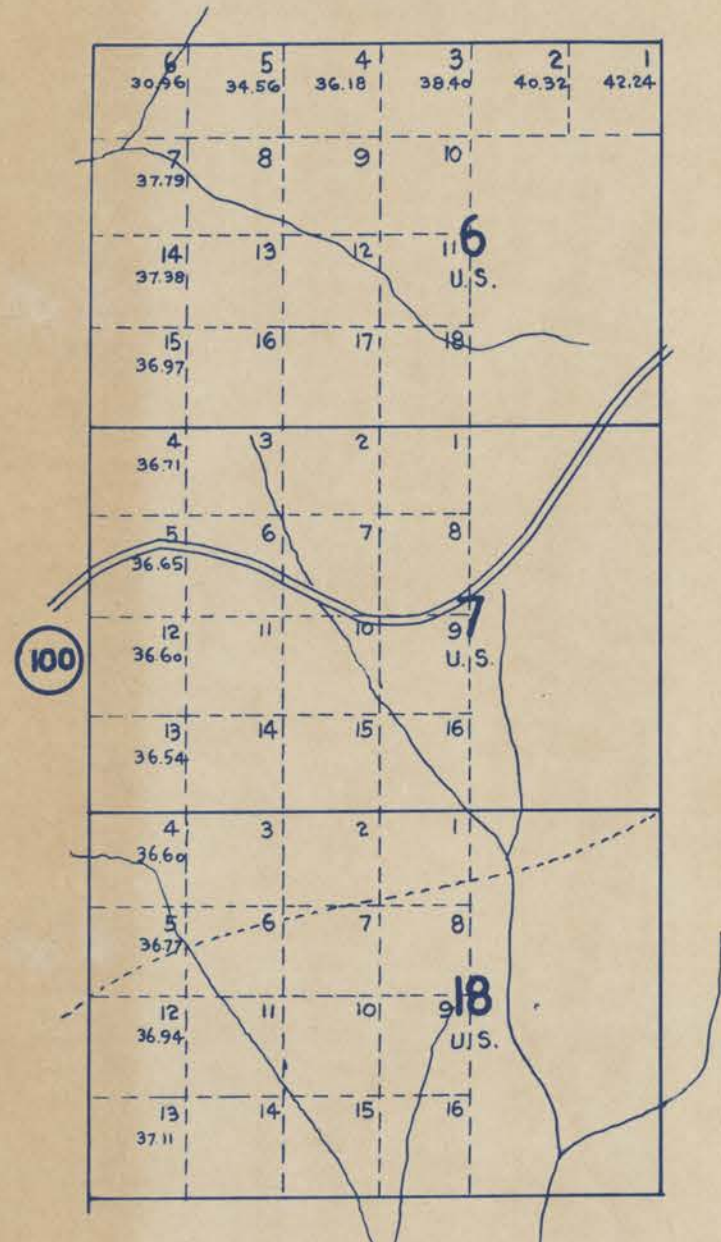

### 5 N. 39 E.

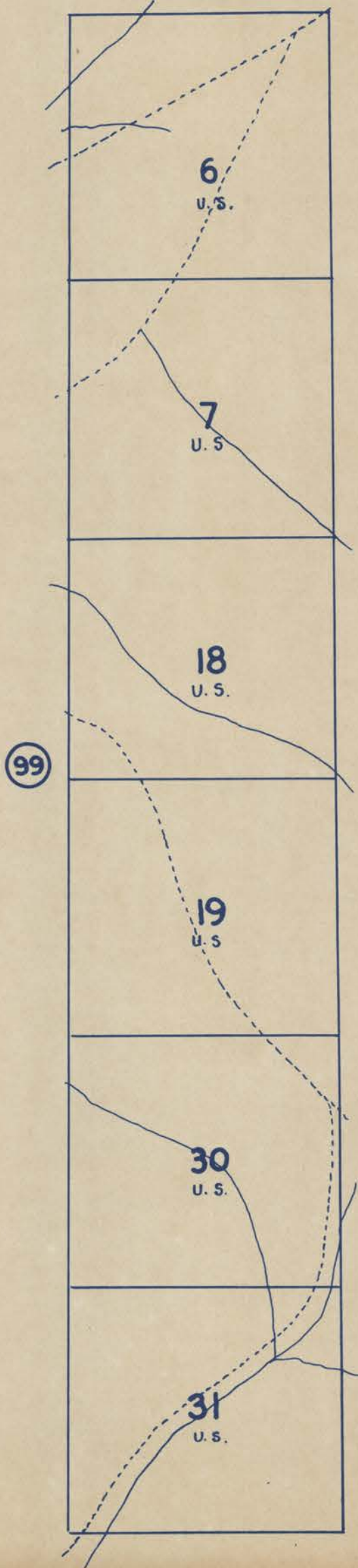

### 6 N. 39 E.

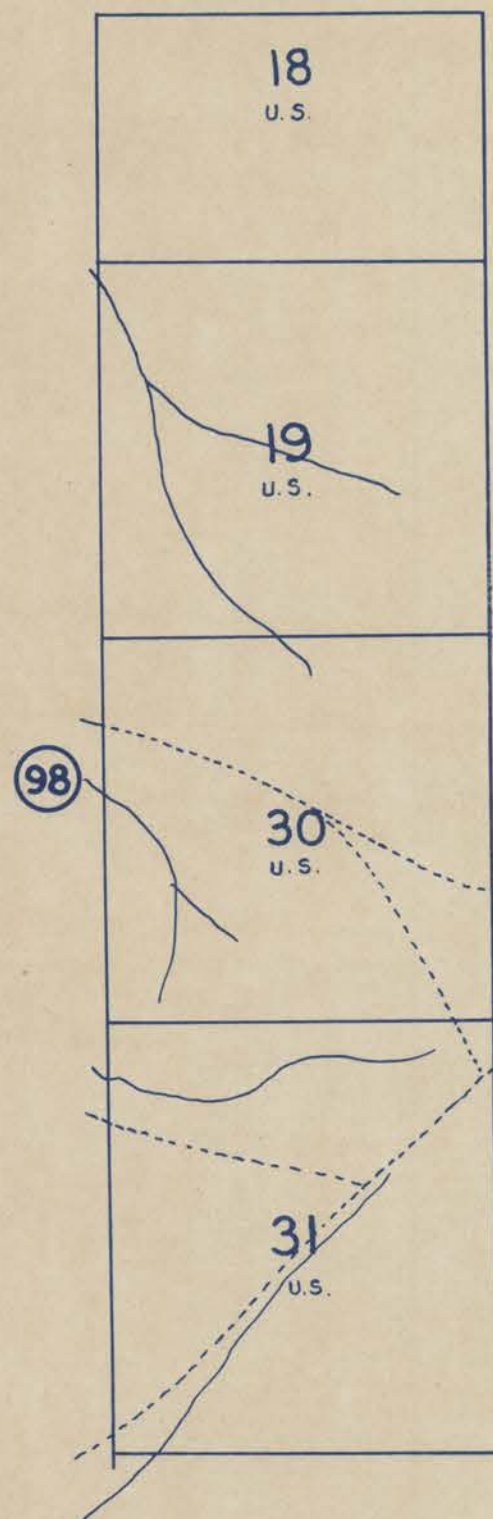

### -LEGEND-

- PAVED ROADS
- STATE HIGHWAYS
- MARKET ROADS
- DIRT ROADS
- INFERIOR ROADS
- RAILROADS
- TRAILS
- INTERMITTENT CREEKS
- SCHOOLS