

TOWNSHIP 1 S., RANGE 35 E.W.M.

SCALE 2 IN. = 1 MILE.
DATED 1932

UMATILLA COUNTY OREGON

CHAS. F. METSKER CIVIL ENGINEER
215 COMMERCE BLDG, PORTLAND, ORE.
930 1/2 PACIFIC AVE, TACOMA, WASH.

- 1 - STATE OF OREGON
- 2 - U. D. CASEY
- 3 - W. C. LOWE
- 4 - GEO. B. GREEN
- 5 - WM. JOHNSON
- 6 - K. P. LODGE NO. 4.
- 7 - ERNEST ALLEN
- 8 - GEO. BLOOMER

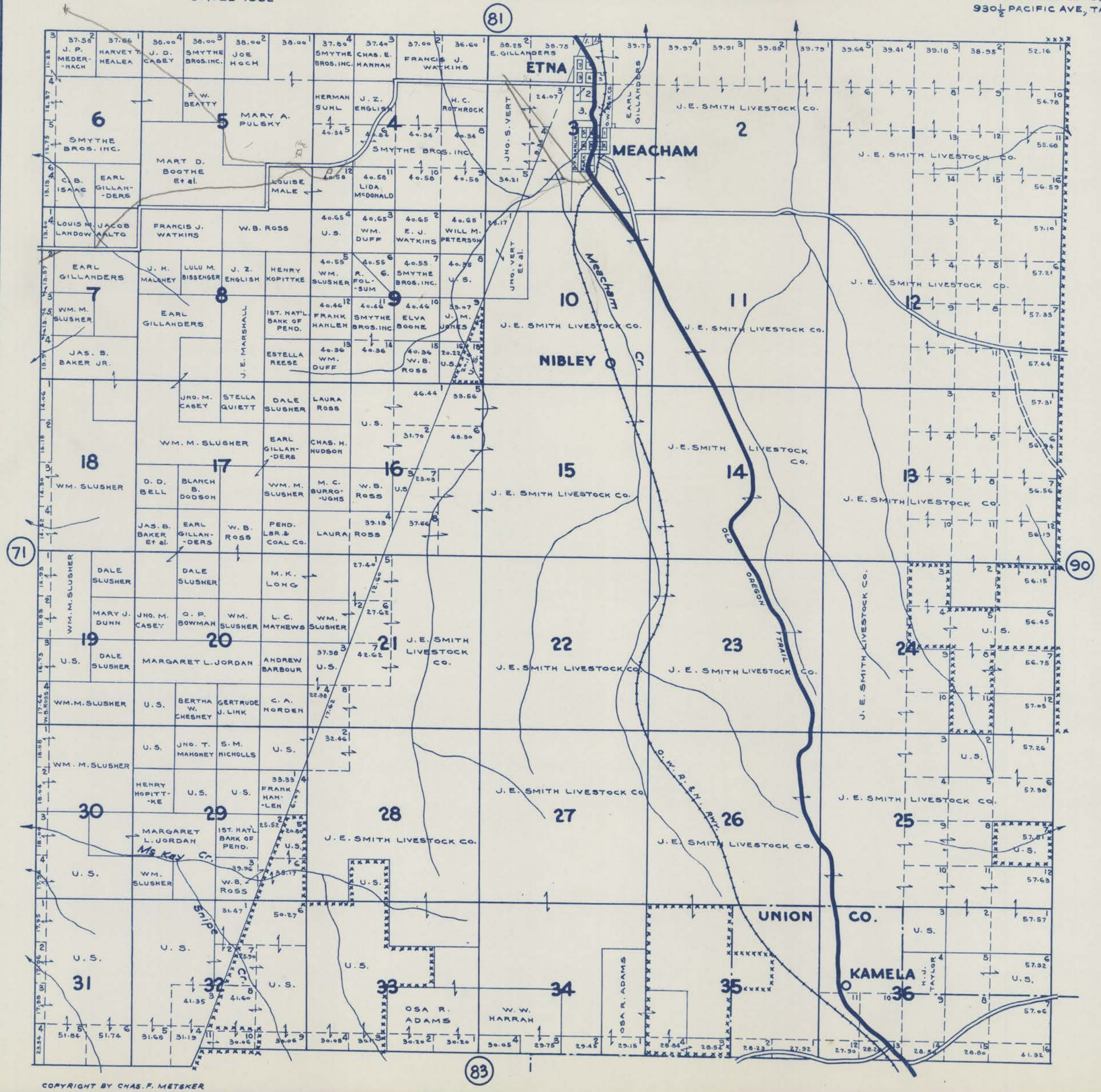

- LEGEND -**
- PAVED ROADS
 - STATE HIGHWAYS
 - MARKET ROADS
 - DIRT ROADS
 - INFERIOR ROADS
 - RAILROADS
 - TRAILS
 - INTERMITTENT CREEKS
 - SCHOOLS