

# TOWNSHIP 4 N., RANGE 29 E.W.M. UMATILLA COUNTY OREGON

SCALE 2 IN. = 1 MILE.  
DATED 1932

CHAS. F. METSKER CIVIL ENGINEER  
215 COMMERCE BLDG. PORTLAND, ORE.  
930 1/2 PACIFIC AVE. TACOMA, WASH.

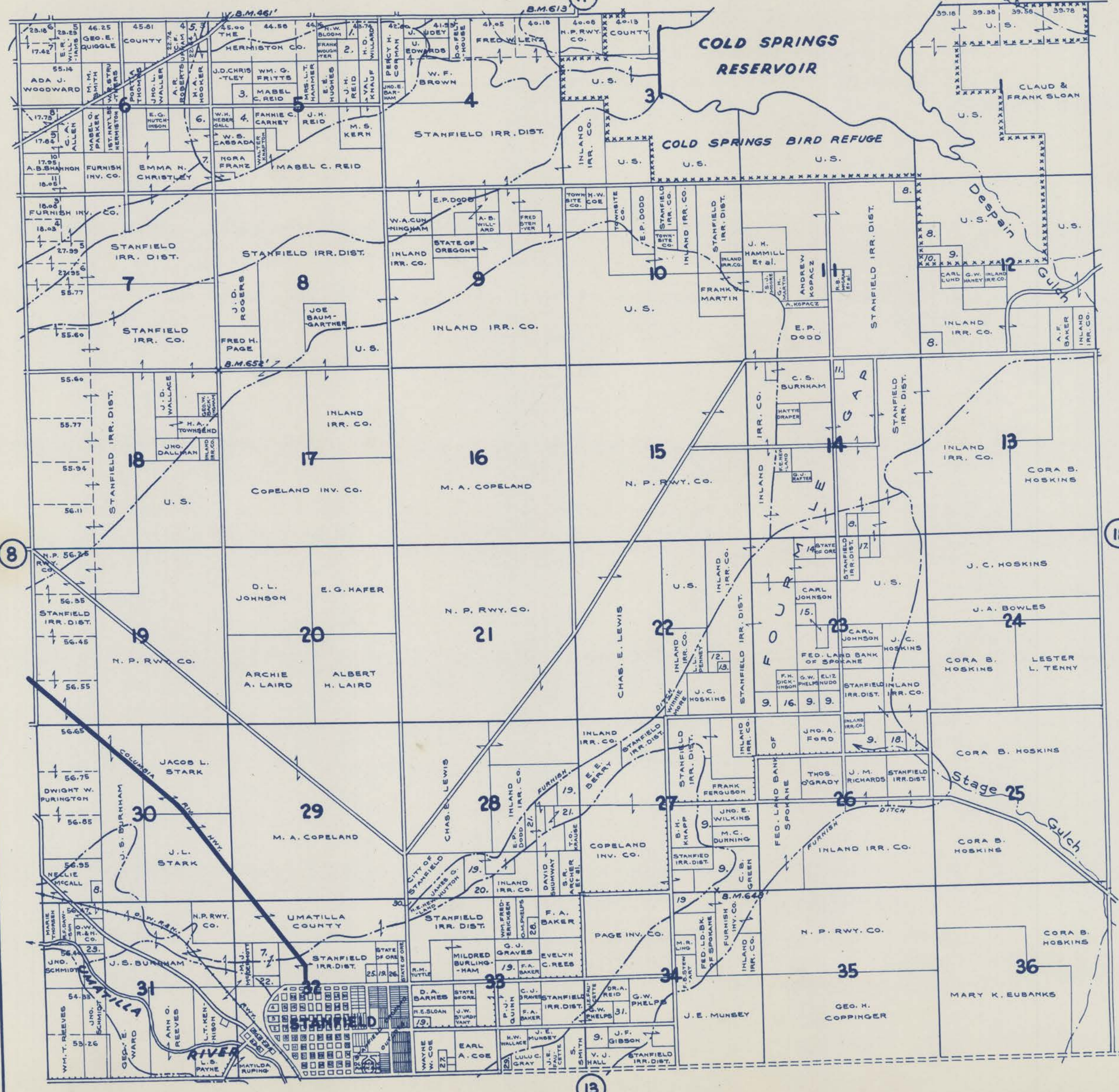

- 1- GEO. W. LIEBE
- 2- FORT WAYNE FRUIT CO.
- 3- PAUL M. MILLER
- 4- J. S. ARNBERG Et al.
- 5- MABEL L. HURST
- 6- HILDRED DAHNER
- 7- WM. A. LEATHERS
- 8- UMATILLA COUNTY
- 9- FED. LD. BANK OF SPOKANE
- 10- HOWARD C. DUNN
- 11- C. H. MAERCKLAIN
- 12- D. PENNEY
- 13- EMMA M. PENNEY
- 14- THOS. MULLIGAN
- 15- ANNIE WEBSTER Et al.
- 16- ANNIE WEBSTER Et al.
- 17- U.C. HOSKINS
- 18- H. F. CHARFEE CO.
- 19- STANFIELD IRR. DIST.
- 20- D. L. JOHNSON
- 21- GOTTLIEB KURRLE
- 22- LEATHERS & LITTLE
- 23- O. M. HOOSIER
- 24- L. F. WOOSTER Et al.
- 25- U. S. GIOYHNE
- 26- TOWNSITE CO.
- 27- O. M. PHELPS
- 28- MARY A. HUTTON
- 29- L. C. GRAY
- 30- INLAND IRR. CO.
- 31- W. U. EDWARDS

- LEGEND -**
- PAVED ROADS
  - STATE HIGHWAYS
  - MARKET ROADS
  - DIRT ROADS
  - INFERRIOR ROADS
  - RAILROADS
  - TRAILS
  - INTERMITTENT CREEKS
  - SCHOOLS